

# SHARP

MX-3610N  
MX-3110N  
MX-2610N

Digital Full Colour Multifunctional System



Innovative User Interface Lets You Make  
the Most of Advanced MFP Functions



COPY

NETWORK PRINT

NETWORK SCAN

SHARPEDESK

FAX  
OPTION

# Tap Into Revolutionary MFP Performance

With flick-tap-slide efficiency, the MX-3610N/3110N/2610N brings the most advanced MFP functions and the unmatched ease of fingertip control. The MX-3610N/3110N/2610N's 10.1-inch colour LCD touchscreen is the gateway to fast, top-quality colour copying and effortless network scanning as well as to ultra-convenient Advanced Preview and Page Editing functions. And while this next-generation powerhouse boasts reliable data safeguarding and impressive environmental performance, it also supports added-value options for Sharp OSA (Open Systems Architecture), faxing, document finishing, and Internet browsing— with every productivity-boosting function just a flick, a tap, or a slide away.

## Next-Generation User Interface

The MX-3610N/3110N/2610N's 10.1-inch colour LCD, Advanced Preview function, and intuitive operation put control at the tip of your fingers, making it easy for even first-time MFP users to navigate. Document finishes like stapling and page layout can be confirmed onscreen before printing out to avoid erroneous printouts and paper waste. And documents can be previewed in various modes, including 3D, edit, and thumbnail, to match the task at hand.



## Web Bro

A Web browsing option adds viewing and printing out Web the MX-3610N/3110N/2610N'

## Choice of Screen Style

The MX-3610N/3110N/2610N offers a choice of six LCD screen colours and a universal-design screen. While the default colour is green, users can easily select their preferred background style.





# Breathtaking Image Quality

Sharp's second-generation Mycrostoner-HG and an improved imaging system combine to allow the full spectrum of colour reproduction in crisp, sharp detail. And because the MX-3610N/3110N/2610N is so easy to operate, breathtakingly high-quality images can be had with just the touch of a finger.

## 2nd-Generation Mycrostoner-HG



## Auto Colour Mode

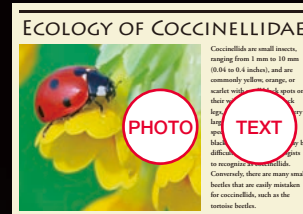

Original

Auto recognition

Text comes out crisp and clear, and unnecessary background colour is automatically removed

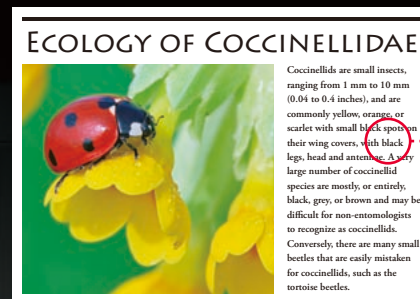

Copy

black spots with black

# Advanced Environmental Performance

The MX-3610N/3110N/2610N boasts state-of-the-art environmental technologies and a range of eco-functions. A short warm-up time is just one of the pluses making this MFP a real energy saver. Dramatically reduced power consumption also means that TEC values\*1 are significantly lower than the maximum allowable values determined by ENERGY STAR®.

\*1 Typical amount of energy consumed in a hypothetical week measured as stipulated under the ENERGY STAR® programme. Value is for total electricity consumed during five days of use, cycling between full operation and Sleep mode or turned off, and two days in Sleep mode or turned off.

### Lower TEC Value

Model	TEC Value (%)	TEC Value (kWh*2)	Max. allowable TEC value (kWh)
MX-3610N	31.3%	3.00 kWh*2	9.60 kWh
MX-3110N	29.7%	2.33 kWh*2	7.85 kWh
MX-2610N	32.0%	1.95 kWh*2	6.10 kWh



### Shorter Warm-Up Time\*3

MX-3610N  
20 seconds  
**83% down**

MX-3110N  
MX-2610N  
20 seconds  
**66% down**

\*2 Measured at 230V. TEC values are as follows when measured at 100V (models for the Japanese market): MX-3610FN: 2.87 kWh, MX-3110FN: 2.37 kWh, MX-2610FN: 1.98 kWh

\*3 Compared to MX-3600FN (for the Japanese market; warm-up time 120 seconds), MX-3100N (warm-up time 60 seconds), and MX-2600N (warm-up time 60 seconds).

## Working

full Internet access for pages and PDF files via LCD—without using a PC!

## PRODUCTIVE

### Super-Efficient Colour and B/W Output

The MX-3610N/3110N/2610N delivers a fast output of **36/31/26 cpm/ppm\*** in B/W and in full colour. And the first copy comes out in just **5.2/5.8/5.9 seconds** in B/W and **6.8/7.9/8.1 seconds** in full colour to save valuable time when performing multiple short-run jobs.

<b>36</b> CPM PPM	<b>31</b> CPM PPM	<b>26</b> CPM PPM
MX-3610N	MX-3110N	MX-2610N

\* A4 (8 1/2" x 11"), long-edge feeding

### Built-In Duplex Module and RSPF

The MX-3610N/3110N/2610N's built-in stackless duplex module can make **two-sided copies and printouts**, effectively reducing paper costs as well as saving filing space. Duplex copying is even more effective with the **100-sheet RSPF** (reversing single pass feeder), which efficiently feeds in either one- or two-sided originals. With a scanning speed of **50 opm** (originals per minute) for both colour and B/W documents, the MX-3610N/3110N/2610N can complete large jobs with ease and efficiency.

### Automated Finishing

The MX-3610N/3110N/2610N automates time-consuming finishing tasks and makes it easy to create professional-looking booklets. The **Saddle Stitch Finisher** option staples documents up to 50 sheets and can fold and staple sets of documents up to 15 sheets to make completed booklets. A space-efficient **Finisher** option is available for jobs that require sorting and stapling. And an optional **Punch Module** allows you to punch holes in documents for easy filing.



### Large Paper Capacity

An optional 3,500-sheet large-capacity tray is available for high-volume work, bringing the total paper capacity to **5,600 sheets**. And for extra-large-volume jobs, the **Auto Tray Switching** function automatically switches to another tray filled with same-size paper.



### Supports Most Office Environments

- The MX-3610N/3110N/2610N works with the latest and most commonly used versions of Windows®, Windows Server®, and Mac operating systems and network protocols—including **IPv6**—even in mixed OS environments. You get fast, powerful network printing via the 1000Base-T **Gigabit Ethernet** standard.
- The MX-3610N/3110N/2610N supports the **PCL6** printer language. For compatibility with **PostScript 3**, the MX-PK11 PS3 Expansion Kit is available.

## A Range of Copy/Print Applications

### Multi Shot and Booklet Making

Thanks to Multi Shot, two to eight pages of a multi-page document can be copied and up to 16 pages can be printed onto a single sheet, reducing paper use. And with the optional Saddle Stitch Finisher, multiple sheets can be automatically centre-stapled together to make booklets.

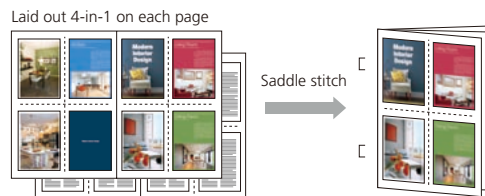

### Custom Images

Customised images prepared by the user, such as a company logo stamp or a "TOP SECRET" watermark, can be used on copies.



### Book Divide

When copying or scanning a booklet or book, the Book Divide function separates the right and left (or the top and bottom) of a two-page spread and outputs each page in the original page order.



### Image Positioning

With this function, a scanned image, such as a photo or an illustration, can be copied onto another document in a position specified by the user. The output can be confirmed beforehand using the Advanced Preview function on the LCD.

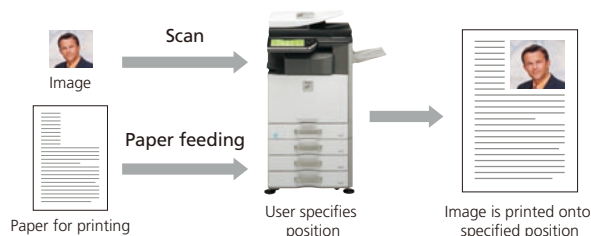

## SUPERB IMAGE QUALITY

### Improved Imaging System



Sharp thoroughly revamped its imaging process for the MX-3610N/3110N/2610N; now a high-performance processor, a new developer, and the **second-generation Mycrostoner-HG** (High Grade) combine to provide breathtaking image quality. The new toner expands the colour reproducibility range for a more natural rendering of clear blue skies, emerald green oceans, and other colour images. And the smaller particle size of the toner and the developer allows for reduced graininess and clear reproduction of fine lines, fine text, and halftone colours.

### High-Resolution Output



The MX-3610N/3110N/2610N delivers 600-dpi copying and razor-sharp **1,200-dpi** printing—without sacrificing output speed. Digital smoothing technology enhances the print and copy resolution to the equivalent of **9,600 x 600 dpi** for incredibly smooth reproduction of fine lines. Fine-grained photographs, detailed illustrations and graphs, and small text come out crisp and clear.

### Easy, High-Quality Copying



**Auto Colour Selection** automatically determines whether a page is colour or B/W and selects the appropriate copy mode for that page. **Auto Colour Mode** analyses the contents of each page, distinguishing between different components, such as photos and text. These two functions allow the MX-3610N/3110N/2610N to print out maps with crisp, clear text and to automatically remove unnecessary background colour from newspaper and magazine copies for clearer output.

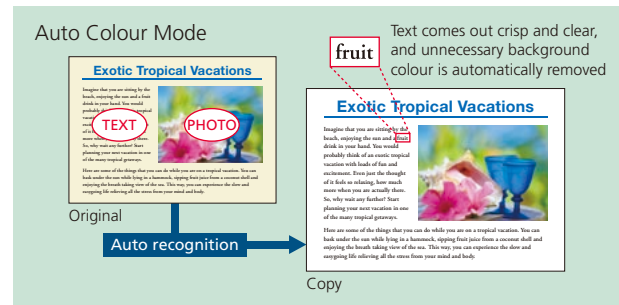

## VERSATILE OPERATION

### Direct Printing\*1



The MX-3610N/3110N/2610N can print PDF\*2, TIFF, JPEG, and XPS\*3 files without using the printer driver. And there's a USB port beneath its control panel, which comes in handy when printing data directly from USB memory devices—an indispensable function for users who are in a hurry or who want quick machine access without a PC.

\*1: Direct printing may not support all PDF, TIFF, JPEG, and XPS formats. \*2: Direct PDF printing requires optional MX-PK11. \*3: Direct XPS printing requires optional MX-PUX1 and MX-SM10.



### Simultaneous Job Processing



The MX-3610N/3110N/2610N makes it easy to simultaneously carry out multiple jobs. Scanned documents can be copied and e-mailed at the same time. And documents can be simultaneously printed and faxed for ultra-convenient multitasking.

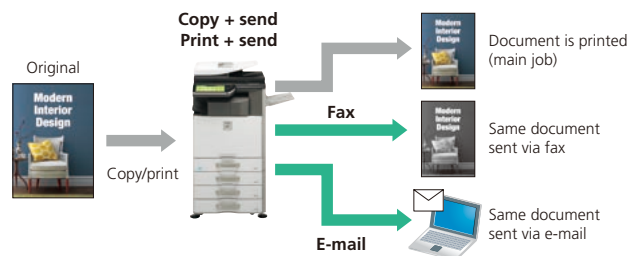

## Other Key Features

### Repeat Layout



Upgraded from the conventional Photo Repeat function, this function can repeat an entire page layout as a single image onto a single sheet.

### Auto Zoom for Irregular-Size Originals



With Auto Zoom, after the user specifies the required finished size of a copy, the MX-3610N/3110N/2610N will automatically calculate the appropriate ratio by which to reduce or enlarge an irregular-size original.

### Layout Print



This function repeats an entire page layout as a single image. The user can specify whether or not to repeat the first page (cover page) of the document.

- **Tab Copy / Tab Print** can copy or print directly onto tabs on document separators and insert them into assigned positions.
- **Card Shot** enables one-touch copying of both sides of a card (credit cards, ID cards, etc.) onto a single page.
- **Carbon Copy Print** mode automatically outputs multiple printouts of the same data on plain and/or coloured paper; convenient for invoices and purchase orders.
- **Form Overlay** can store office document formatting such as letterheads and overlay contents in colour, eliminating the need for pre-printed paper.
- **Barcode font** compatibility (requires optional MX-PF10)
- **Colour Stamp** labels your copies with page numbers, the date or text such as "Urgent" in up to four different colours.
- **Book Copy** is convenient for compiling copies of a book or bound originals into pamphlet format.
- **Multi-Page Enlargement** divides an image onto separate sheets for making posters up to A0 x 2 (44" x 68") in size.



# IMAGE SENDING

: Scan : Fax

## A3 Colour Network Scanning

The MX-3610N/3110N/2610N works as a **full-colour network scanner** and supports TIFF, PDF, encrypted PDF, compact PDF\*, PDF/A, XPS, and JPEG file formats. Converting any type of paper-based document, up to A3 (11" x 17") in size, into an editable digital file is as easy as making a copy. Enhanced scan performance improves the legibility of extremely fine text and allows vivid colour reproduction in scanned documents. **Auto Colour Selection** chooses the right mode for scanning originals containing both colour and B/W pages (see page 4). And five levels of sharpness and contrast control enable finely tuned adjustments for optimal image quality.

\* Requires optional MX-EB11.

## Drop Out Colour

This function removes chromatic colour from a scanned image, reducing the data size for compact storage and enhancing the legibility of B/W text to improve the text recognition rate before OCR.

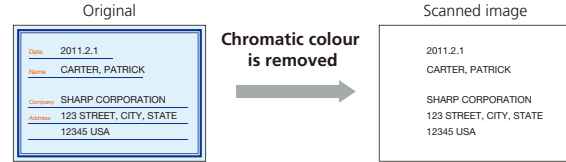

## Multiple Distribution of Scanned Files

With just a few taps on the LCD touchscreen, you can choose different ways to distribute your scanned documents. **Scan to E-mail** sends documents as an e-mail attachment. **Scan to FTP Server** scans documents directly to an FTP server for storage. **Scan to Desktop** sends scanned documents directly to your PC desktop. **Scan to Network Folder (SMB)** sends files to a shared folder on a networked Windows PC. **Scan to External Memory Device** scans documents directly to USB memory devices. And **Scan to Fax** enables conventional faxing or Internet faxing.

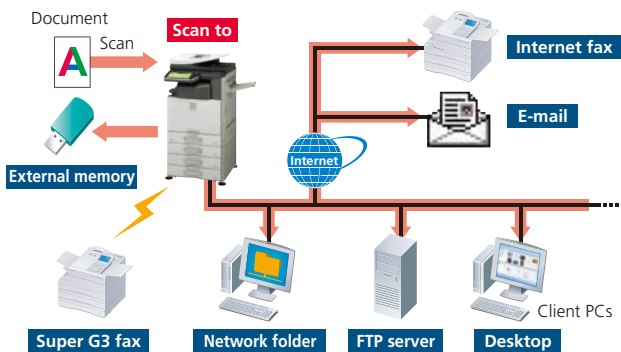

## Black Letter Emphasis

When text-heavy documents are scanned, this function improves the legibility of B/W text while keeping the file size down. Text is scanned at high resolution while the rest of the document, including photos and illustrations, is scanned at a lower resolution.

## Improved Address Book

With the MX-3610N/3110N/2610N's improved address book format, up to seven destinations, including e-mail addresses, fax numbers, and FTP addresses, can be displayed under each registered entry. For enhanced security, when registering an entry, you can select whether the information will be open to all MFP users or limited to only designated users or groups. And since only the viewable addresses for each logged-in user are displayed, the list of addresses is narrowed down, making address searches easier.

## PC-Fax/PC-Internet Fax

Directly send a document created on your PC to a recipient's fax machine via a phone line or the Internet without printing to paper. Save time and paper costs while retaining original document quality. Note: PC-Internet Fax requires optional MX-FWX1; PC-Fax requires MX-FX11.

## One Scan/Multi Format

This function allows you to specify image resolution or colour for each mode of broadcasting employed. For example, when sending the same image data to both a fax and an e-mail destination, you can send a B/W version via fax and a full-colour version via e-mail.

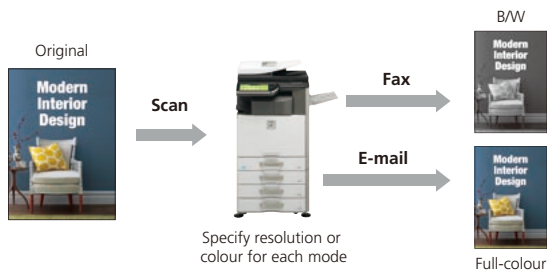

## Internet Fax

Economically send and receive faxes to and from other T-37-compliant Internet fax machines via the Internet. Thanks to **Direct SMTP** support, outgoing Internet faxes do not go through your mail server, making transmission faster and cheaper.

Note: Requires optional MX-FWX1.

## Paperless Faxing with Inbound Routing

Paperless faxing with inbound routing lets you check incoming faxes via e-mail before printing them out. It can also forward incoming faxes to destinations—another fax/Internet fax machine, an FTP server, a network folder (SMB), or a PC desktop—specified for each sender.

## LDAP Support

Built-in LDAP (lightweight directory access protocol) support eliminates the need to enter or register full addresses. When you enter the first few letters of the recipient's name, the MX-3610N/3110N/2610N displays a list of possible matches from your company's LDAP server. Selected addresses can be stored to the MX-3610N/3110N/2610N's address book.

## Fax Data Storage on MFP Hard Disk

The MX-3610N/3110N/2610N lets you select important fax data from the Received Fax Data List, store it on the MFP's hard disk, and manage it via the Document Filing function. (See page 6.)

## Time-Specified Fax Output

The MX-3610N/3110N/2610N can withhold output of incoming faxes until a user-specified time: during lunch break, for example, when the MFP is not heavily used.



# DOCUMENT MANAGEMENT

## Document Management on the Hard Disk

You can save processed job data in designated folders on the MFP's hard disk, making it easy to instantly recall saved documents or jobs for printing and sending at a later time. This contributes greatly to efficient sharing and distribution of information in your business operations.

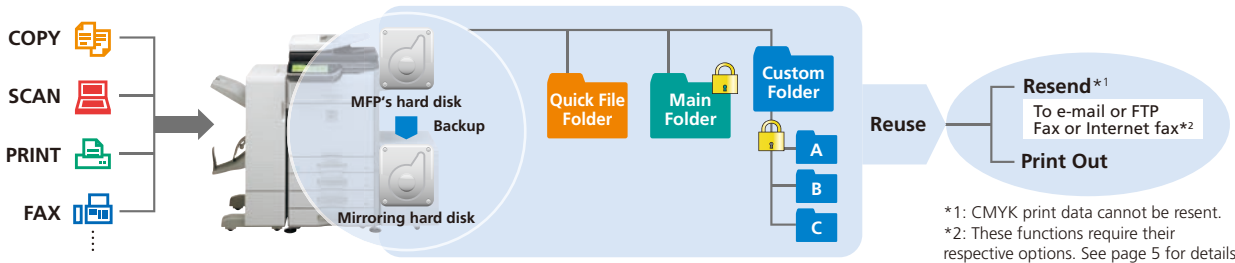

\*1: CMYK print data cannot be resent.  
\*2: These functions require their respective options. See page 5 for details.

### Quick Filing

Up to **10,000 pages** or 1,000 files\* that have been copied, printed, scanned, or faxed can be stored by job on the hard disk in a Quick File Folder. You can easily reuse saved data without having to reload or rescan the original.

### Advanced Filing Function

Up to **20,000 pages** or 3,000 files\* that have been copied, printed, scanned, or faxed can be stored by job on the hard disk in up to 1,000 folders with customised names and locations. Enhanced security features require users to enter a 5- to 8-digit password to access secure folders, protecting your sensitive data. Storage options include Main Folder for workgroup sharing and Custom Folder for enhanced-security archiving.

\* Measured using Sharp's standard chart (A4 with 6% coverage, B/W). The storage capacity will be less for colour pages.

## Easy Access to Stored Files

Documents stored on the hard disk can be quickly and easily searched and accessed from the control panel's LCD via thumbnail displays and file previews or through a Web browser.



Thumbnail displays



Web access screen

## Easy Sharing of Application Files

The MX-3610N/3110N/2610N's hard disk enables files created with applications such as Word and Excel® to be saved in their original file format and shared across the office network.

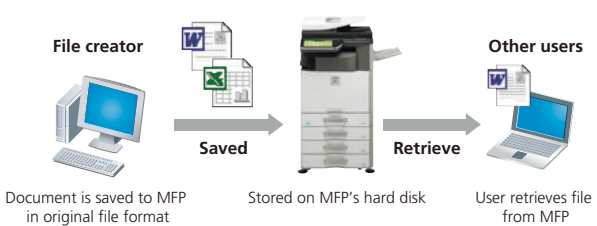

Document is saved to MFP in original file format      Stored on MFP's hard disk      User retrieves file from MFP

## File Combining

For more effective data utilisation, two files saved on the MFP's hard disk can be easily combined into one file.

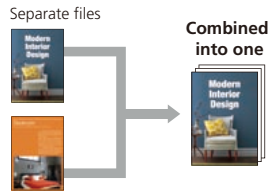

## PDFs for PC Browsing

Processed job data can be saved as PDF files for browsing and downloading on a PC.

## Mirroring Kit

To protect the enhanced data handling capability of the MFP's hard disk, which provides improved Document Filing functions and easy sharing of application files, the optional Mirroring Kit offers hard disk backup and peace of mind.

## Sharpdesk for Total Document Management

Sharpdesk is an original Sharp application that provides integrated desktop management of documents in over **200 file formats**, including scanned paper-based documents and those created with popular applications such as Word. It allows you to organise, edit, search, and distribute your documents, all with simple drag-and-drop operation.

- Intuitive desktop display features **thumbnail** viewing
- Sharpdesk Imaging provides **annotation** tools for paper-free proofreading
- Sharpdesk **Composer** combines different types of files into a single document
- **Optical character recognition** converts documents into editable text files
- **Output zone** distributes files to e-mail, printers, and other applications
- **File search** allows searching by file name, keyword, or thumbnail

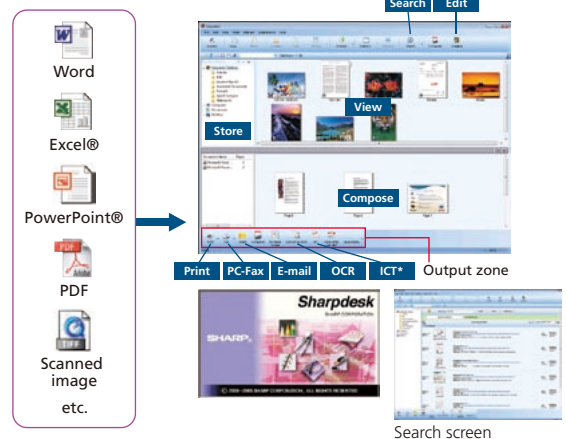

\* Image Compression Tool for converting images into compact PDF files







# DEVICE MANAGEMENT

## Web-Based System Settings

Administrators can manage every important setting—including user access and security as well as other controls and configurations—through a standard Web browser right from their desktops.



Web-based device management

## Network Utility Software

Sharp Remote Device Manager (SRDM) gives administrators centralised, real-time control of their networked MFPs through a standard Web browser, making device cloning, firmware updates, and everything else easier and more accessible.

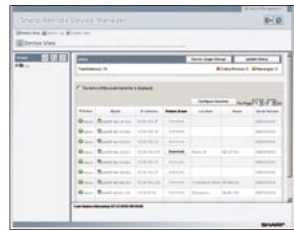

Web-based SRDM

## Remote Diagnosis

The MX-3610N/3110N/2610N can be monitored remotely through a Web browser, letting administrators handle tasks before they become problems. And when action or maintenance is required, the **E-Mail Status and Alert** function notifies administrators via timely e-mail alerts.

## Remote Operation

The Remote Operation function lets you display the MFP's main control panel on your PC screen, allowing you to operate every major function directly from your desktop.\* This function also enables the administrator to guide an MFP user through necessary procedures and allows remote MFP operation from a wheelchair.

\* Requires VNC application.



# ENVIRONMENT-FRIENDLY

## Outstanding Energy Efficiency

To reduce power consumption, Sharp has applied its advanced technologies across all areas of this MFP, including the hardware, software, electrical system, and supplies. As a result, the MX-3610N/3110N/2610N boasts one of the lowest power consumption rates in its class.

- Sharp's belt fusing system shortens the MX-3610N/3110N/2610N's warm-up time to **20 seconds**, contributing to reduced overall energy consumption.
- Based on prior usage patterns, the MX-3610N/3110N/2610N automatically determines the optimal length of time to let elapse before going into auto power shut-off mode, helping reduce overall power consumption.
- **Power ON/OFF Schedule** function automatically turns the MX-3610N/3110N/2610N on or off according to time schedules set by the administrator.

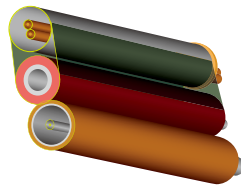

- **Eco Scan** function saves energy by turning off power to the fusing system during jobs that don't require any printing, such as Image Sending and Document Filing.
- Second-generation Mycrostoner-HG has a **lower melting point** than conventional toner, allowing fusing to be carried out with less energy. It also offers a significantly lower consumption rate than conventional toner.

- For further energy savings, energy-efficient **LED lamps** are employed in the scan unit in place of conventional xenon lamps. A new ASIC (application-specific integrated circuit) also helps the MX-3610N/3110N/2610N deliver excellent performance and energy efficiency.

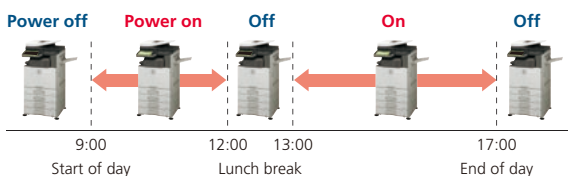
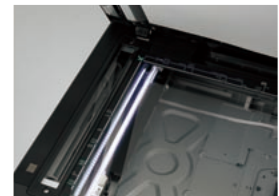

# EASE OF USE

## 10.1-Inch Colour LCD Touchscreen

MFP operation has never been so intuitive, so easy! The MX-3610N/3110N/2610's control panel features a wide, clear, WVGA-resolution LCD touchscreen. Simply touch, tap, flick, or slide a finger on the screen for effortless control of every document, function, and setting. And for strain-free viewing, the MX-3610N/3110N/2610's user interface employs a smooth, bold scalable font in sizes that vary in line with the content on display.

## Advanced Preview

The Advanced Preview function saves you time and effort by displaying scanned images on the LCD for confirmation and editing. Document finishes, such as page layout and stapling, can be checked before the documents are printed out. Previewed pages can be easily rotated, put in a different order, and deleted via tap-and-drag editing right on the LCD. You can even erase specific parts of a previewed page and insert blank pages.



Edit on the LCD

## Customisable Screen

The Home screen can be customised for individual users by programming their most frequently used functions and settings and creating **shortcut keys** for quick and easy access. The **Enlarge Display** mode brings added readability.

## On-Screen User Manual

Stored on the MX-3610N/3110N/2610's hard disk for quick and easy reference, the user manual can be readily accessed for viewing on the large LCD.

## Action Panel

The Action Panel appears on the right side of the touchscreen to guide you through operational procedures. The MFP intuits what actions to take next and the Action Panel displays shortcut keys and messages pertaining to those actions.

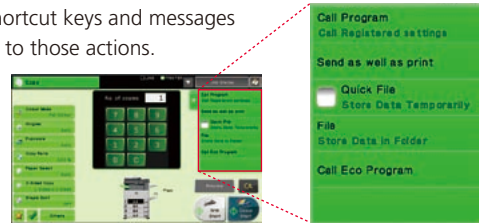

## Universal Design

- The control panel can be **tilted** to five different angles\* for easy viewing, even from a wheelchair.  
\* If an optional finisher is installed, the number of angles is limited to two: the top and second from the top.



- **Easy-grip handles** allow the paper drawers to be grasped from the top as well as the bottom for easy opening and closing.

## Retractable Keyboard (option)

A **full-size retractable QWERTY keyboard** slides out from beneath the control panel to make text input fast and easy: convenient for typing things like e-mail addresses and messages, as well as passwords for user authentication.



# EXPANDABILITY

## Direct Internet Access

The optional **Web Browsing Expansion Kit** gives you direct access to the Internet for easy browsing of Web sites on the colour touchscreen. With such quick access to information, brochures and user manuals in PDF\* format as well as maps and coupons can be printed out on the spot.

\* PDF printing requires optional MX-PK11.

## Sharp OSA Network Scanner Tool

This client-based scan-to-desktop option is the ideal document management system for small workgroups or offices that don't have servers. Sharp OSA Network Scanner Tool provides centralised scan/print user profiles to give everyone in the office easy one-touch scanning to their PC from any networked MFP—without complicated settings. Scanned documents can be quickly and easily printed, filed, previewed, shared, and stored to save time and improve document workflow. And Sharp OSA Network Scanner Tool automatically names PDF files based on scanned-document titles and can convert scanned documents into text with the OCR engine to create searchable PDF files.



## Sharp OSA (Open Systems Architecture)

Innovative Sharp OSA\* technology allows you to interact with critical business and network applications right from the LCD control panel, offering a new realm of control and convenience. And since Sharp OSA utilises industry-standard network protocols, the MX-3610N/3110N/2610N can easily integrate with document management systems, enterprise resource planning software, workflow applications, and more. The latest version of Sharp OSA can **reach beyond the firewall**, enabling extensive system construction and services over the Internet. Sharp OSA brings benefits such as reducing the costs associated with system implementation and management, as well as enabling data sharing across company branch offices or subsidiaries—effectively enhancing total business efficiency.

\* Requires optional MX-AMX2 and/or MX-AMX3.

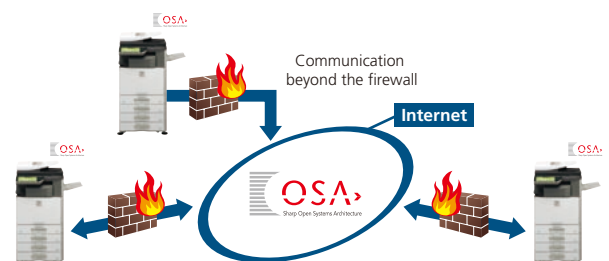

# OPTIONS

## System Configuration

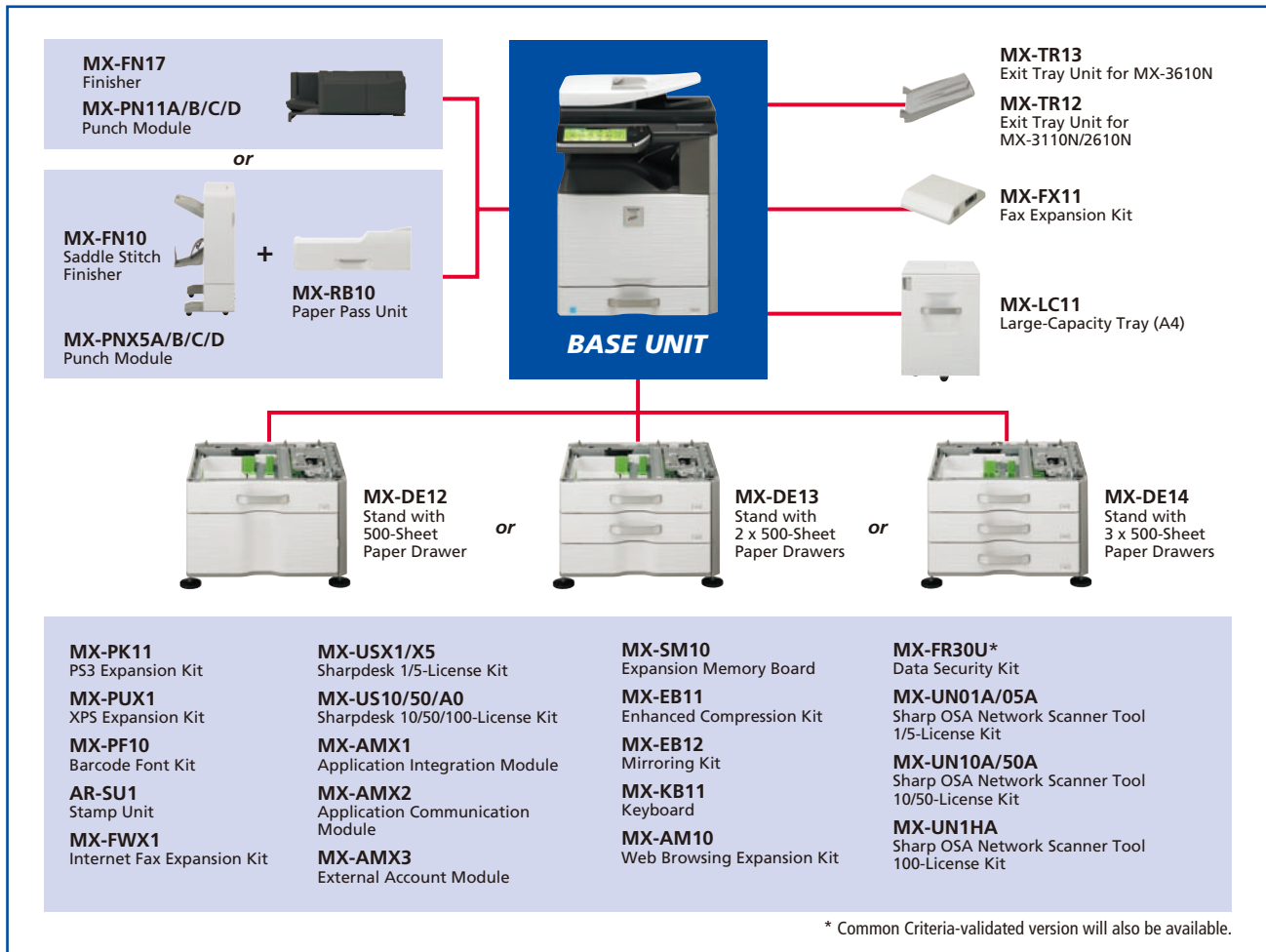

Certain options may not be available in some areas.

## Specifications for Options

### MX-FN17 Finisher

Paper size	Non offset	A3W to A5R (12" x 18" to 5 1/2" x 8 1/2"R)
	Offset/staple	A3 to B5 (11" x 17" to 8 1/2" x 11"R)
Max. paper capacity		500 sheets (A4, 8 1/2" x 11"), 250 sheets (A3, 11" x 17")
Stapling capacity		50 sheets (A4 or smaller), 30 sheets (B4 or larger)
Staple position		3 locations (front, rear or both)

### MX-FN10 Saddle Stitch Finisher

Paper size	Non offset	A3W to A5R (12" x 18" to 5 1/2" x 8 1/2"R)
	Offset/staple	A3 to B5R (11" x 17" to 8 1/2" x 11"R)
Max. paper capacity	Offset tray	1,000 sheets (A4 or smaller, except A5R), 500 sheets (A5R, B4 or larger)
	Saddle stitch tray	10 sets of 11–15 sheets, 15 sets of 6–10 sheets, 20 sets of 1–5 sheets
	Stapling capacity	50 sheets (A4 or smaller), 25 sheets (B4 or larger)
Staple position		3 locations (front, rear or both)

### Punch Modules

Model name	For the MX-FN17	MX-PN11A	MX-PN11B	MX-PN11C	MX-PN11D
	For the MX-FN10	MX-PNX5A	MX-PNX5B	MX-PNX5C	MX-PNX5D
Number of holes		2	2/3	4	4 (wide)
Paper weight		55 to 256 g/m <sup>2</sup> *			

\* Guaranteed punchable weight is 55 to 128 g/m<sup>2</sup>.

### MX-DE12 Stand with 500-Sheet Paper Drawer

Paper size	A3 to A5R (11" x 17" to 5 1/2" x 8 1/2"R)
Paper capacity	500 sheets

### MX-DE13 Stand with 2 x 500-Sheet Paper Drawers

Paper size (upper and lower tray)	A3 to A5R (11" x 17" to 5 1/2" x 8 1/2"R)
Paper capacity (upper and lower tray)	500 sheets each

### MX-DE14 Stand with 3 x 500-Sheet Paper Drawers

Paper size (upper/middle/lower tray)	A3 to A5R (11" x 17" to 5 1/2" x 8 1/2"R)
Paper capacity (upper/middle/lower tray)	500 sheets each

### MX-LC11 Large-Capacity Tray

Paper size	A4, B5 (8 1/2" x 11")
Paper capacity	3,500 sheets

### MX-FX11 Fax Expansion Kit

Compression method	MH/MR/MMR/JBIG
Communication protocol	Super G3/G3
Modem speed	33,600 bps to 2,400 bps

Note: All specifications relating to paper capacity refer to 80 g/m<sup>2</sup> paper.

Note: When using Sharpdesk, Sharp OSA Network Scanner Tool, and Sharp OSA, please ask your Sharp representative about PC system requirements.



**SPECIFICATIONS** (tentative)

**General**

Type	Desktop
Engine speed (colour & B/W)	Max. 36/31/26 cpm/ppm (A4, 8 1/2" x 11", long-edge feeding)
Paper size	Max. A3 wide (12" x 18"), min. A5R (5 1/2" x 8 1/2"R)
Paper capacity (80 g/m <sup>2</sup> )	Standard: 600 sheets (500-sheet tray and 100-sheet multi-bypass tray) Maximum: 5,600 sheets
Paper weight	Tray: 60 g/m <sup>2</sup> to 209 g/m <sup>2</sup> (16 lbs bond to 110 lbs index) Multi-bypass tray: 55 g/m <sup>2</sup> to 256 g/m <sup>2</sup> (13 lbs bond to 140 lbs index)
Warm-up time*1	20 sec.
Memory	[Standard] Copy/print (shared): 3GB 160GB HDD*2 [Option] Print: 1GB
Power requirements	Rated local AC voltage ±10%, 50/60 Hz
Power consumption (max.)	1.84 kW (220 to 240V), 1.44 kW (110 to 127V)
Dimensions (W x D x H)	MX-3610N: 608 x 680 x 834 mm (23 15/16" x 26 25/32" x 32 61/64") MX-3110N/2610N: 583 x 658 x 834 mm (22 61/64" x 25 15/16" x 32 61/64")
Weight (approx.)	MX-3610N: 76 kg (167.5 lbs) [110 to 127V] / 77 kg (169.8 lbs) [220 to 240V] MX-3110N/2610N: 74 kg (163.1 lbs)
Features	Job build, document filing, user authentication (1,000 accounts), toner save mode, pre-heat/auto power shut-off modes, advanced preview, etc.

**Copier**

Original paper size	Max. A3 (11" x 17")
First copy time*3	[MX-3610N] Full colour: 6.8 sec. B/W: 5.2 sec. [MX-3110N] Full colour: 7.9 sec. B/W: 5.8 sec. [MX-2610N] Full colour: 8.1 sec. B/W: 5.9 sec.
Continuous copy	Max. 999 copies
Resolution	Scan (colour): 600 x 600 dpi Scan (B/W): 600 x 600 dpi, 600 x 400 dpi, 600 x 300 dpi Print: 600 x 600 dpi, 9,600 (equivalent) x 600 dpi (depending on print mode)
Gradation	Equivalent to 256 levels
Zoom range	25 to 400% (25 to 200% using RSPF) in 1% increments
Preset copy ratios	Metric: 10 ratios (5R/5E), inch: 8 ratios (4R/4E)
Features	Auto paper selection (mixed/random size feeding), auto magnification selection, paper type selection, auto tray switching, rotation copy, electronic sorting, network tandem copy, book copy, margin shift, dual page copy, multi-shot (8/4/2-in-1), cover/transparency/tab page insertion, pamphlet copy, 2-sided copy orientation change, XY zoom, B/W reverse, mirror image, duplex copy, job reservation, job programme, repeat layout, irregular original/paper size input, stamps (watermark, date, page number, text, stamp), multi-page enlargement, tab copy, centering, proof copy, auto colour mode, auto colour selection, auto calibration, sharpness, card shot, original count, edge/centre/side erase, blank page skip, position image, book divide, hidden pattern print, tracking information print, custom image, etc.

**Network Scanner**

Scan method	Push scan (via control panel), pull scan (TWAIN-compliant application)
Resolution	Push scan: 100, 150, 200, 300, 400, 600 dpi Pull scan: 75, 100, 150, 200, 300, 400, 600 dpi 50 to 9,600 dpi via user setting*4
File formats	TIFF, PDF, encrypted PDF, JPEG, XPS*, compact PDF*6, PDF/A
Scanner utility	Sharpdesk
Scan destinations	Scan to e-mail/desktop/FTP server/network folder (SMB)/external memory device
Features	Internet fax*7 (supports direct SMTP), PC-Internet fax transmission*7, auto colour mode, mixed size original scanning, LDAP support, direct entry (address, subject, message), 2,000 one-touch dials, 500 group dials, 48 job programmes, broadcasting, long original scanning (max. 1,000 mm)*8, auto colour selection, card shot, original count, edge/side erase, drop-out color, one scan/multi format, book divide, blank page skip, black letter emphasis, etc.

\*1: At rated voltage, 23°C (73.4°F). May vary depending on operating conditions and environment. \*2: HDD capacity depends on procurement and sourcing status. \*3: Long-edge feeding of A4 (8 1/2" x 11") sheets from 1st paper tray, using document glass, without Auto Colour Selection and Auto Colour mode, MFP in fully ready condition. May vary depending on operating conditions and environment. \*4: Resolutions higher than 600 dpi are interpolated. \*5: To view XPS files on PCs not running Windows Vista, you must have the XPS Viewer application installed. \*6: Optional MX-EB11 required. \*7: Optional MX-FWX1 required. \*8: B/W documents only, scanned at under 400-dpi resolution. \*9: Measured using Sharp's standard chart (A4 with 6% coverage, B/W). The storage capacity will be less for colour pages. \*10: Some features require option(s). \*11: Optional MX-PK11 required for Mac OS and EtherTalk. \*12: PS requires optional MX-PK11. XPS requires optional MX-PUX1 and MX-SM10 (1GB). \*13: Some features are not available according to the printer driver used. \*14: Based on Sharp's standard chart with approx. 700 characters (A4 or 8 1/2" x 11" long-edge feeding) at standard resolution in Super G3 mode, 33,600 bps, JBIG compression.

• Design and specifications are subject to change without prior notice. • Windows, Windows Server, Windows Vista, and Excel are registered trademarks of Microsoft Corporation in the United States and/or other countries. All other brand names and product names may be trademarks or registered trademarks of their respective owners. • The ENERGY STAR logo is a certification mark and may only be used to certify products that have been determined to meet the ENERGY STAR programme requirements. ENERGY STAR is a US registered mark. The ENERGY STAR guidelines apply to products only in the US, the EU, Japan, Canada, Australia, New Zealand, and Taiwan.

**Document Filing**

Document filing capacity	Main and custom folders: 20,000 pages**9 or 3,000 files Quick file folder: 10,000 pages**9 or 1,000 files
Stored jobs*10	Copy, print, scan, fax
Storage folders	Quick file folder, main folder, custom folder (max. 1,000 folders)
Confidential storage	Password protection (for main and custom folders)

**Network Printer**

Resolution	1,200 x 1,200 dpi, 600 x 600 dpi, 9,600 (equivalent) x 600 dpi
Interface	USB 2.0, 10Base-T/100Base-TX/1000Base-T
Supported OS**11	Windows Server® 2003/2008, Windows® 2000/XP, Windows Vista®, Windows® 7, Mac OS 9.0 to 9.2.2, Mac OS X 10.2.8, 10.3.9, 10.4.11, 10.5 to 10.5.8, 10.6.5
Network protocols**11	TCP/IP (IPv4, IPv6), IPX/SPX (NetWare), NetBEUI, EtherTalk (AppleTalk)
Printing protocols	LPR, Raw TCP (port 9100), POP3 (e-mail printing), HTTP, Novell Printserver application with NDS and Bindery, FTP for downloading print files, EtherTalk printing, IPP
PDL (emulation)	Standard: PCL 6 emulation Option**12: PS3 emulation, XPS
Available fonts	80 fonts for PCL, 136 fonts for PS3 emulation
Features*10 *13	Network tandem print, RIP Once/Print Many, job retention (proof print, confidential print), direct PDF/TIFF/JPEG/XPS printing, carbon copy print, duplex print, font/form download, offset output, pamphlet style, Sharp Remote Device Manager, printer status monitor, layout print, IP/MAC address filtering, port/protocol management, binding edge, N-up (2/4/6/8/9/16), paper/output tray selection, cover/transparency insertion, fit to page, watermarks, form overlay, auto configuration, barcode font compatibility, tab print, poster print, margin shift, secure network communications (SSL and IPsec [LPD]), tracking information print, hidden pattern print, etc.

**B/W Facsimile (optional MX-FX11 required)**

Compression method	MH/MR/MMR/JBIG
Communication protocol	Super G3/G3
Transmission time	Less than 3 seconds*14
Modem speed	33,600 bps to 2,400 bps with automatic fallback
Transmission resolution	From Standard (203.2 x 97.8 dpi) to Ultra Fine (406.4 x 391 dpi)
Recording width	A3 to A5 (11" x 17" to 5 1/2" x 8 1/2")
Memory	1GB (built-in)
Grey scale levels	Equivalent to 256 levels
Features	Duplex transmission/reception, quick on-line transmission, error correction mode, 2,000 one-touch dials, 500 group dials, LDAP support, 48 job programmes, broadcasting number registration, F-Code compatibility (confidential, relay broadcast), polling, memory transmission/reception, auto reduction (transmission/reception), rotation transmission/reception, print actual size, 2-in-1 transmission, long original transmission (max. 1,000 mm), PC-Fax transmission, timer transmission, inbound routing to e-mail/FTP server/network folder (SMB)/PC desktop/fax/Internet fax, activity report, anti-junk fax, dual page scan, mixed size original scanning, card shot, edge/side erase, original count, etc.

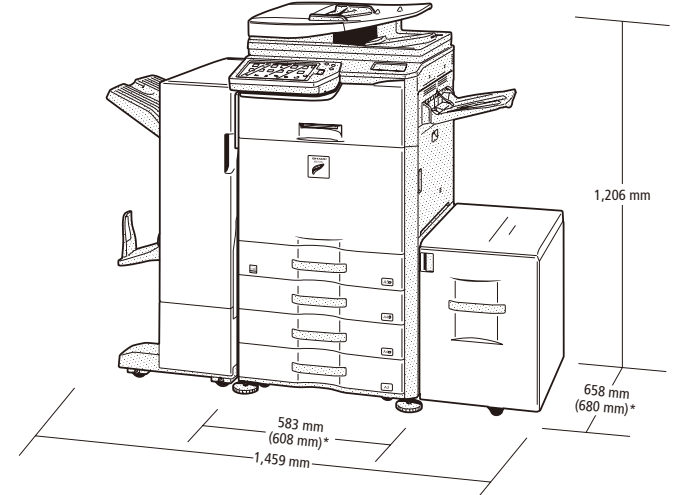

\* MX-3610N dimensions MX-3110N/2610N shown with options.

Distributed by:



Printed with environmentally friendly vegetable oil-based ink.